

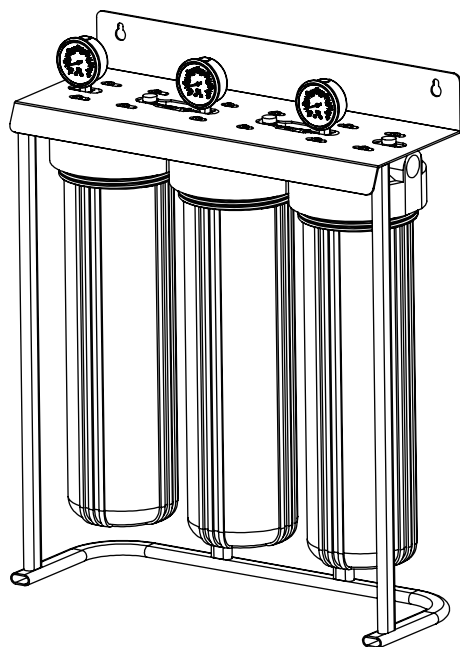

Whole House Water Filtration System

User Manual



Respected user:

Thanks for choosing this whole house water purification water system. The water purifier uses food-grade materials, respectively through PP filter, pre carbon filter, post carbon filter or customized filters, it is a type of filter that cleans most of the incoming and outgoing water through out your entire home, please read this instruction before using the system.

CAUTION: Improperly installed systems could result in water damage due to leaks or flooding. Proper installation of this system accordance with the Local country Plumbing Code/Rule and proper use of common hand and power tools. If you are not familiar with standard sink plumbing and proper use of common hand and power tools or have any difficulty with the installation of this system, consult a licensed professional, such as a contractor or plumber.

What included in carton

- 1 Complete filter system with cartridges inside
- 2 Spanner
- 3 Manual

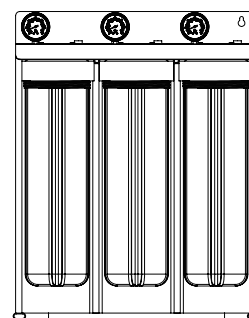

1 system with 3 filter cartridges

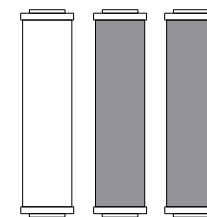

Spanner

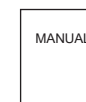

Manual

1.Note before using

In order to use this product more safely, please pay attention to the following descriptions.

- ① Use a licensed plumber to install the system.
- ② The filter system should be protected from freezing, or extreme temperatures, and kept clean and level.
- ③ Where line pressure exceeds 520 kPa, a pressure limiting valve must be installed. Protect the housing from water hammer.
- ④ Use on cold water line only (with water up to 52°C). For installation over 52°C please enquire as to a suitable housing.
- ⑤ Use seal tape on all connections and do not overtighten. Too much tape or over tightening may cause head to split.
- ⑥ Do not use with water that is microbiologically unsafe or with water of unknown quality without adequate disinfection.
- ⑦ The cartridges in the system must be replaced on a regular basis to maintain efficiency and to ensure high water quality.
- ⑧ All types filters life are depend on the inlet water quality and using amount, suggest change every 6-12 months.
- ⑨ Should be regularly examined for leakage deterioration and replaced.
- ⑩ Turn off the inlet water if trvealling out long time.
- ⑪ Avoid installing in direct sunlight.
- ⑫ This device should be installed downstream of a backflow prevention device.

This manual is suitable for our all series of filter systems, like 10 inch, 20 inch, with frame, without frame, with cover, without cover and 2 stages, 3 stages etc.

In order to improve product performance, product components are subject to change without notice, please refer to the actual product.

2.How to install

① Prepare the system:

- a, if your system is with cover then remove the cover and take out the cartridges from the housing body, need remove the plastic wrap from the cartridges
- b, do not inset the cartridges back now , leave the cartridges and filter housing body at side
- c, do below steps first

② Prepare the pipes:

- a, turn off the main line water shutoff valve to the house.
- b, open all plumbing fixtures in the house in order to drain the lines of as much water as possible.
- c, the system should be placed on the main water supply line near where it enters the house.
- d, drill holes on the wall according to the hole templet supplied, allow 50mm clearance underbowl for filter changes (if your system is without a standing).
- e, measure, cut, and remove a section of the main incoming water line near where the system is to be installed. When determining the length of pipe to cut, account for filter width, shut off valves, union fittings, nipple fittings, pressure gauges (if used) and bypass valve (if used).
- f, allow this line to drain thoroughly. Smooth the newly cut ends down to avoid jagged points or edges.
- g, suggest placing a shutoff valve immediately on either side of the filter for future ease of service.
- h, securely mount the system, ensure that the system is level.
- i, flush debris from pipework.

- ③ Insert the cartridges to the filter housing, and tighten with the spanner (be sure to note inlet and outlet markings. The sediment filter is the first stage of the system)

3.How to replace the cartridges

- ① Turn off the water supply to the system. Depress the red pressure release button on the top of the filter housing to relieve system pressure.
- ② Unscrew the housing from the cap using the spanner included with your system (if your system is with a cover then remove it first). Remove and discard the old filter cartridge.
- ③ Scrub the housing and cap with warm water mixed with about 2 tablespoons of household bleach, using a sponge or soft rag. Wear rubber gloves. Rinse all parts very thoroughly!
- ④ Check o-ring(s) for damage and if there is any, replace please.
- ⑤ Remove all packaging from new filter cartridge(s) and insert into housing making sure cartridge(s) is properly seated over spigot in base of housings.
- ⑥ Fit the bottom of the housing into the cap and hand tighten. Then use the spanner to fit snug. Do not over tighten.
- ⑦ Close any open valves. Slowly turn on the water supply to allow the system to fill with water. Inspect carefully for leaks. If a leak is found, first remove the housing and inspect the o-ring to ensure that it is seated properly. Then retighten.
- ⑧ Flush the system by turning on a few cold-water faucets. Allow the water to run until the air and carbon has been purged. Water may initially be cloudy. New activated carbon filter cartridges may contain loose carbon and air bubbles after installation.

4.Components & Specification

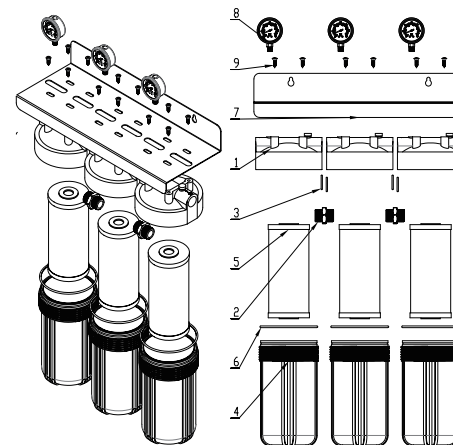

No.	Name	Descriptions	Qty
1	Housing cap		3
2	Fitting	Connect with the filter housings	2
3	Fitting seal		2
4	Filter housing	10*4.5 or 20*4.5 size with food grade materials	3
5	PP filter	Effectively adsorb sediment, rust and other suspended particles in the water with 10 micro aperture	1
	CTO filter	reduces tastes and odours and decreases manganese and zinc with 5 micro aperture	2
6	O-ring	Filter housing seal	6
7	Bracket	Stainless steel type or painting iron type	1
8	Pressure gauge (some modes without gauge)	Read the water pressure of the outgoing and incoming water for easy monitoring	3
9	Screws	Stainless steel type or normal type	12